

## Government Aircraft Factories N22 Nomad

Dimensions:	Prototype:	Model:
Span:	14.5 m	711mm (28.0 in)
Length:	12.57 m	547 mm (21.5 in)
Wing area:	30.2 m <sup>2</sup>	5.12 dm <sup>2</sup> (79.4 in <sup>2</sup> )
T/O Weight:	3,856 kg	72 g (2.6 oz)
Scale:		1 : 23.1

Designed by Derek Buckmaster

Website:  
[www.hotkey.net.au/~ue626](http://www.hotkey.net.au/~ue626)

e-mail:  
[derekb@unite.com.au](mailto:derekb@unite.com.au)

© D Buckmaster 2001

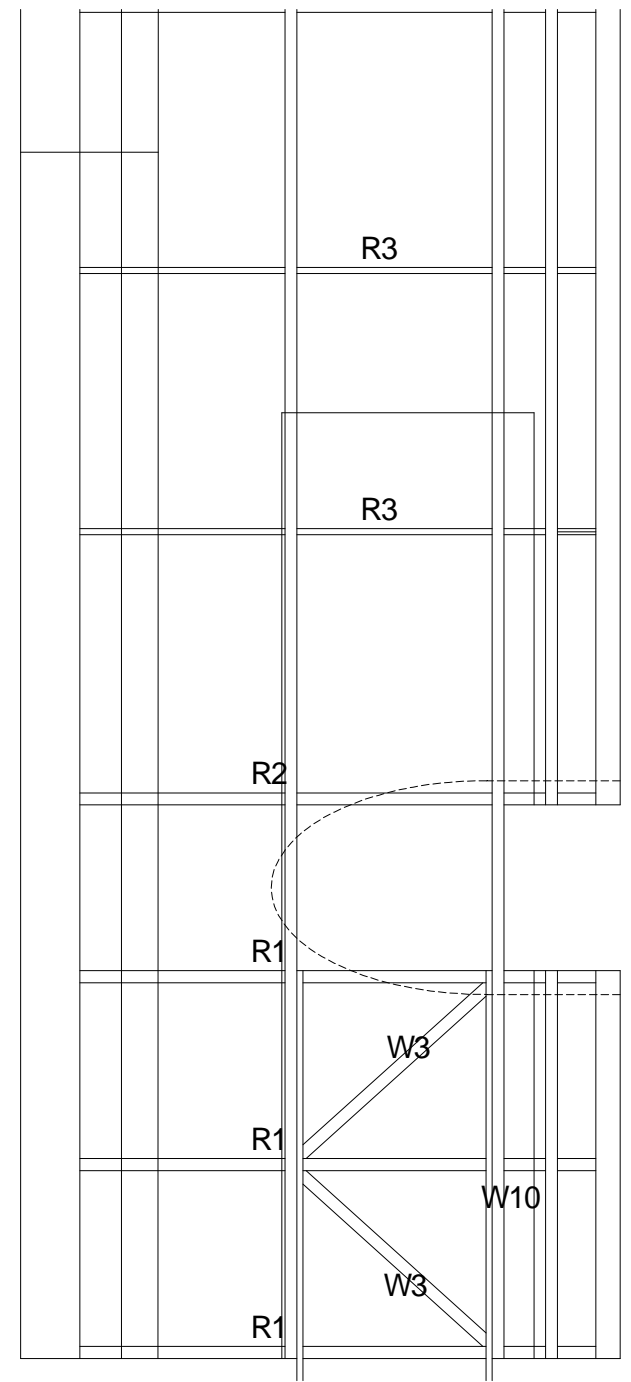
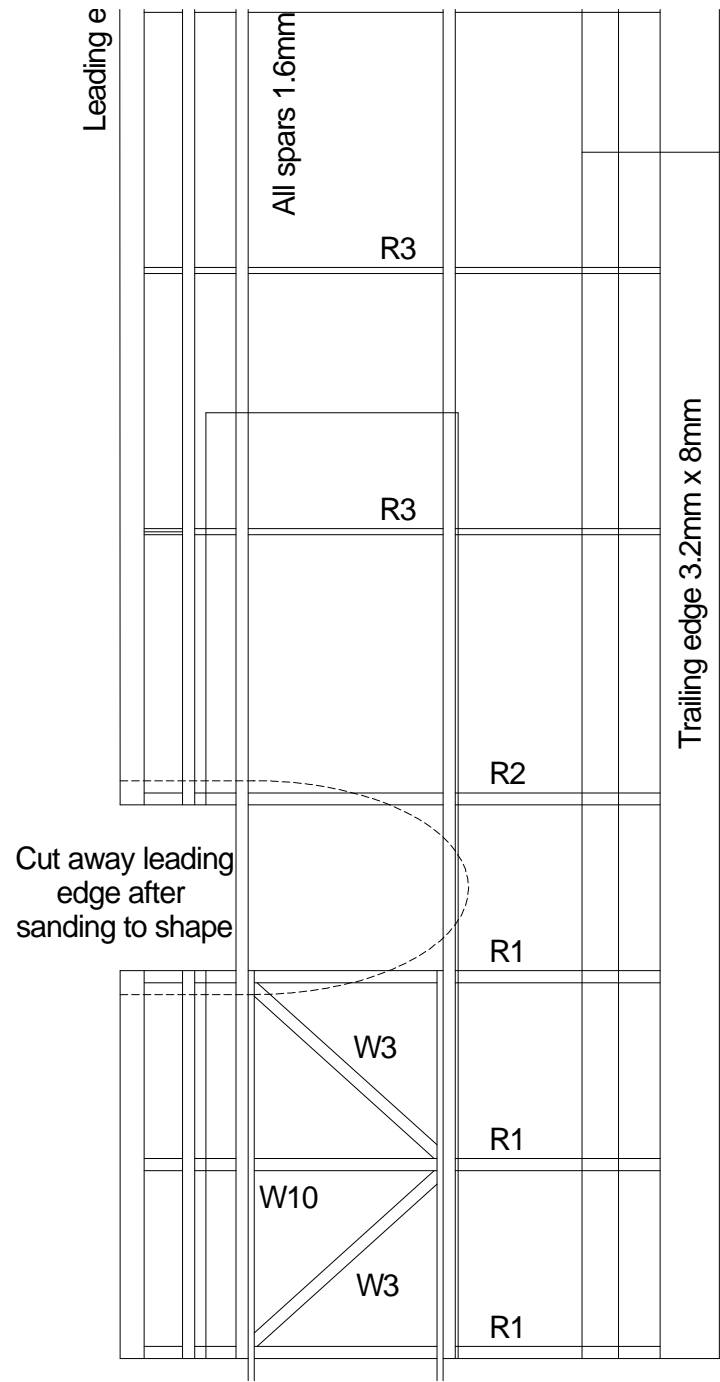

Tailplane incidence adjustment:

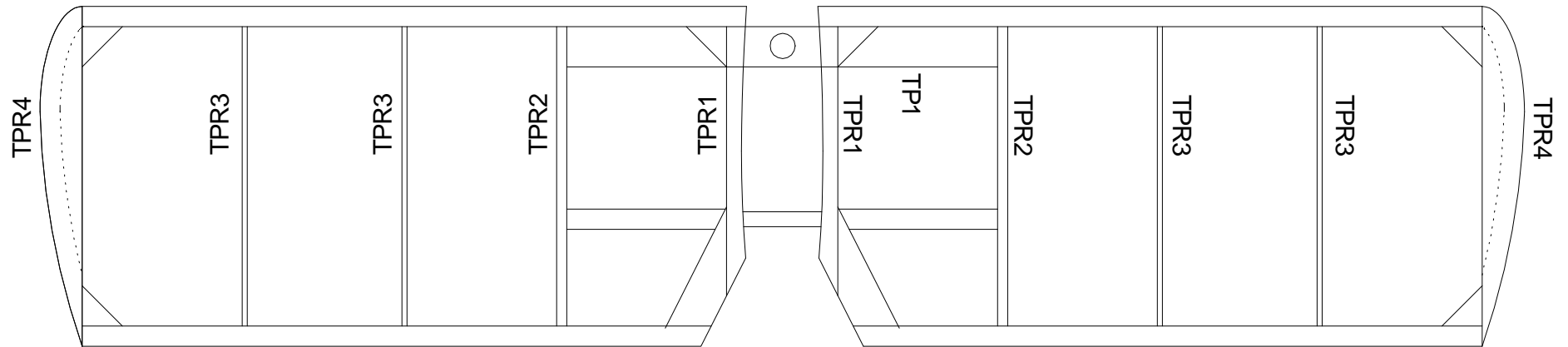
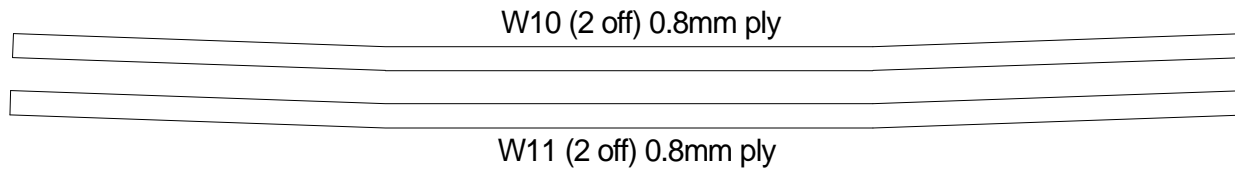
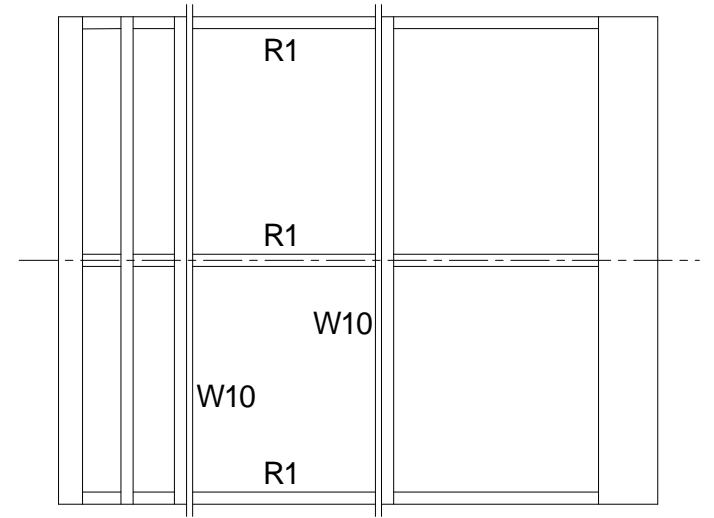
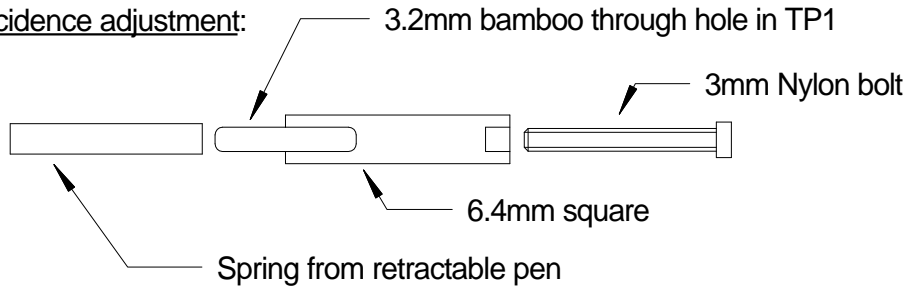

Sheet 4 of 4

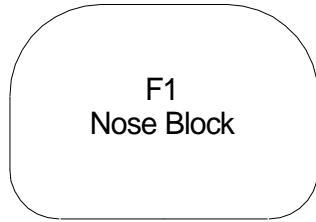

F17 (2 off)  
2.4 mm

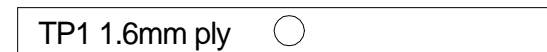
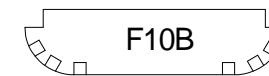
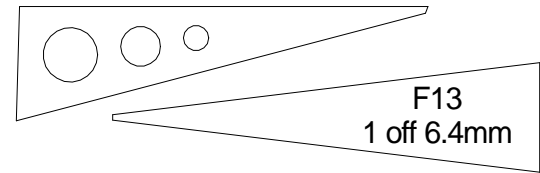
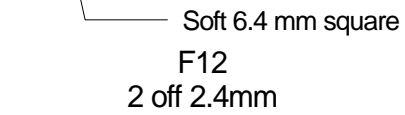
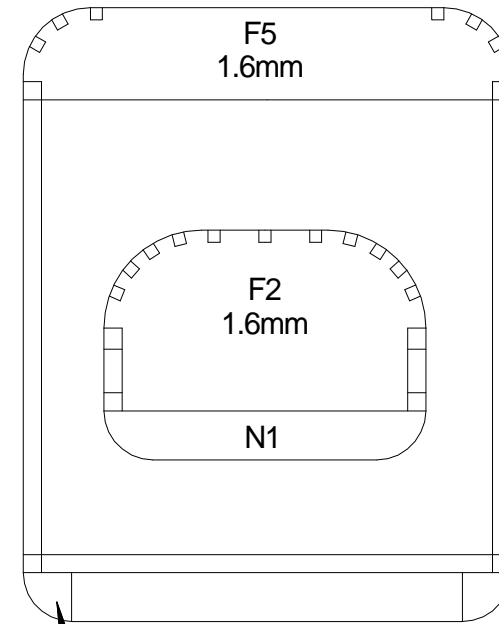
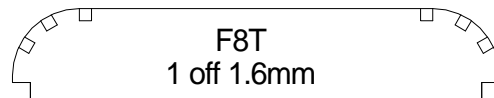
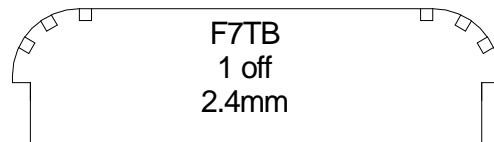
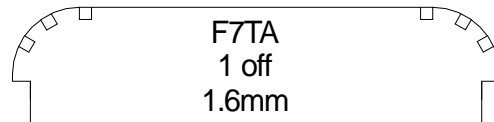
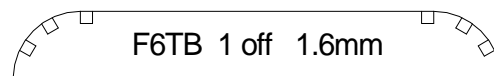
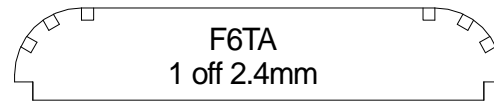
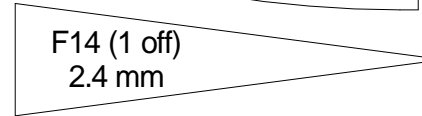
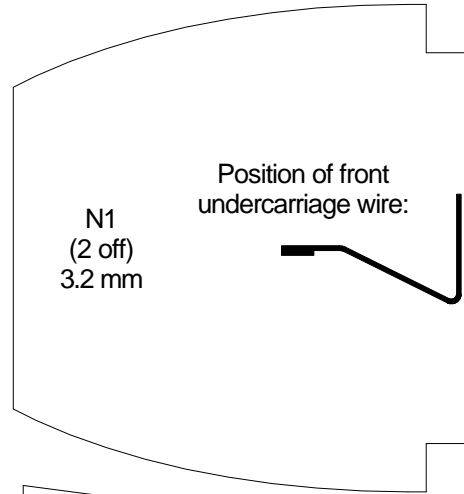
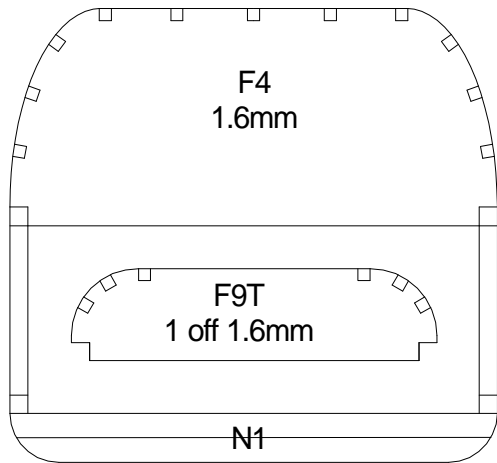
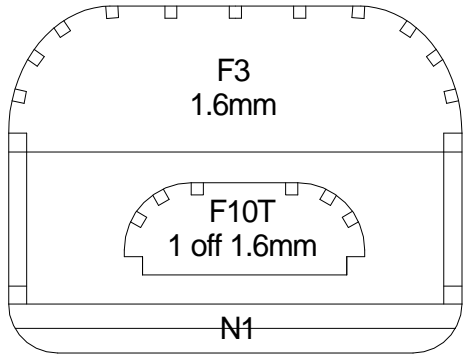

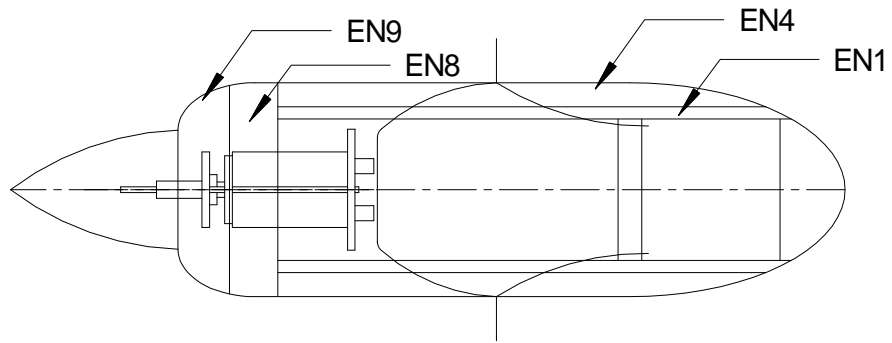
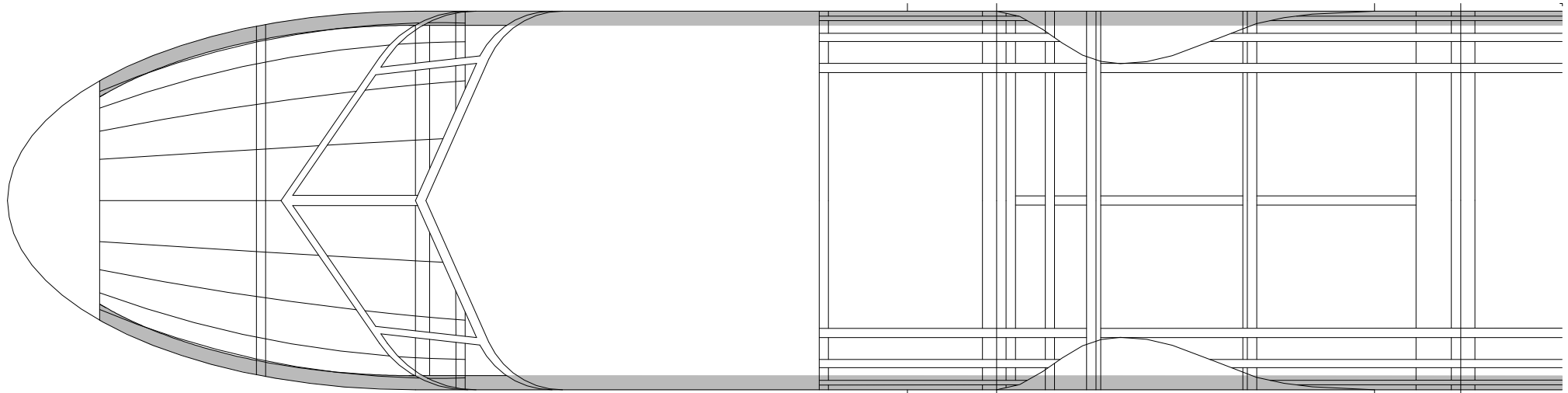

**Engine nacelle top view**

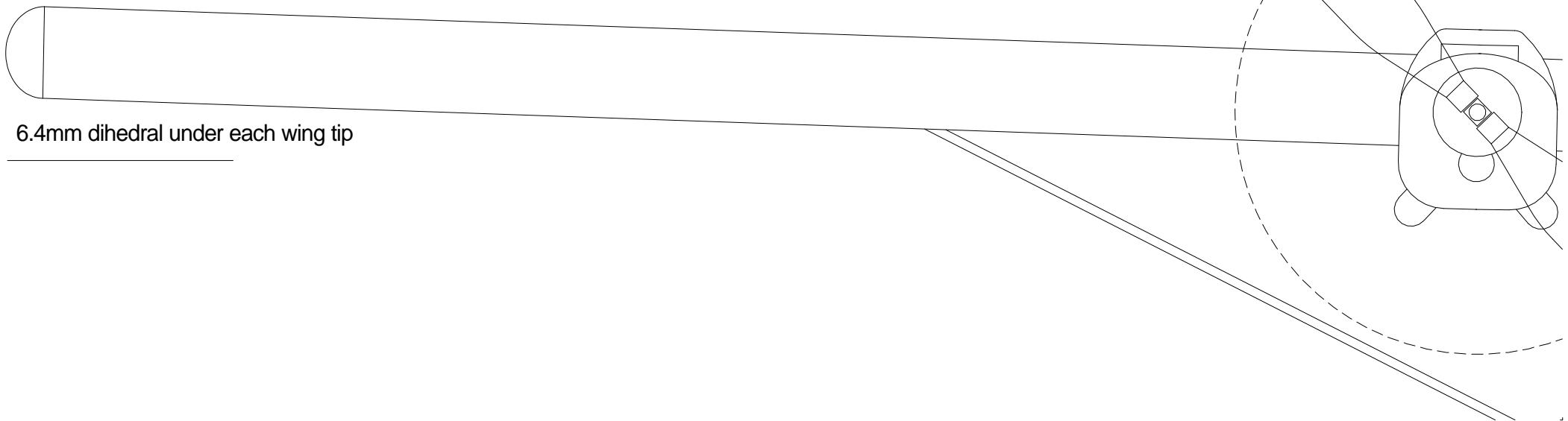
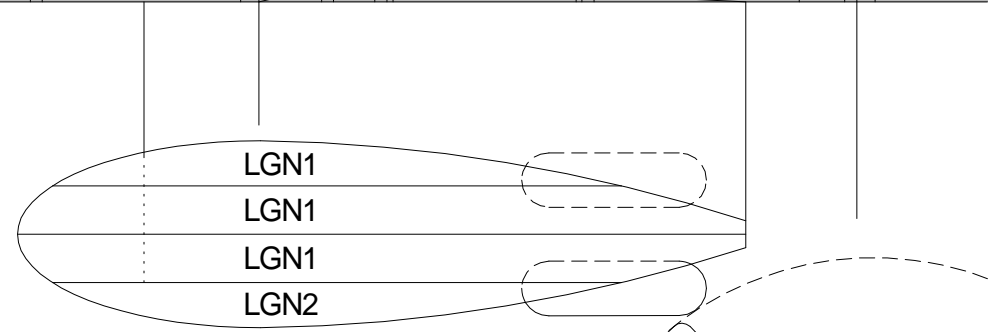

6.4mm dihedral under each wing tip

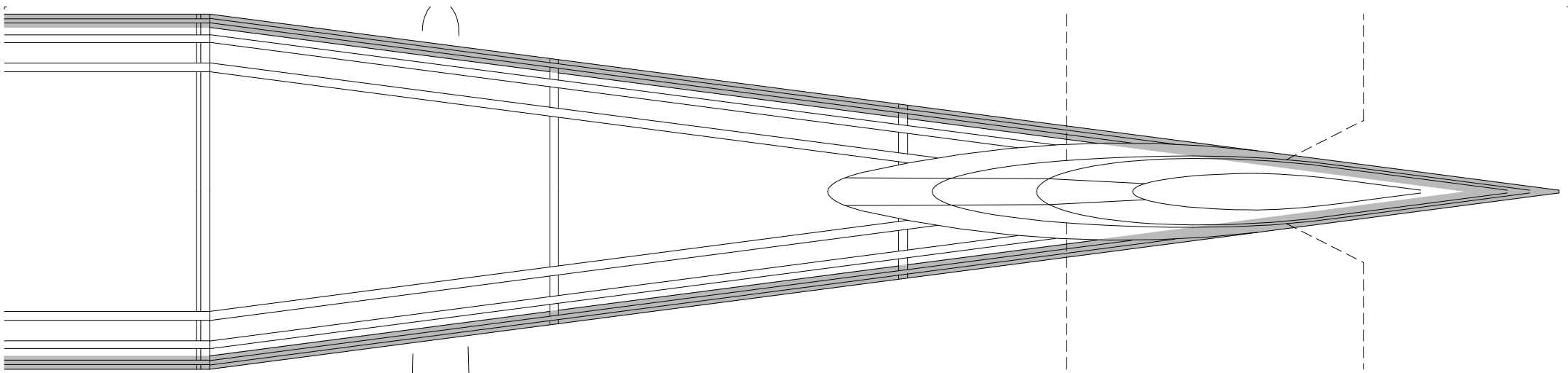

Fuselage construction:

- Main side frames (shaded in gray) from 2.4mm square
- Diagonal bracing and window frames from 2.4 x 1.6mm strip
- Stringers on nose and rounded corners from 1.6mm square
- Top and bottom formers from 1.6mm sheet

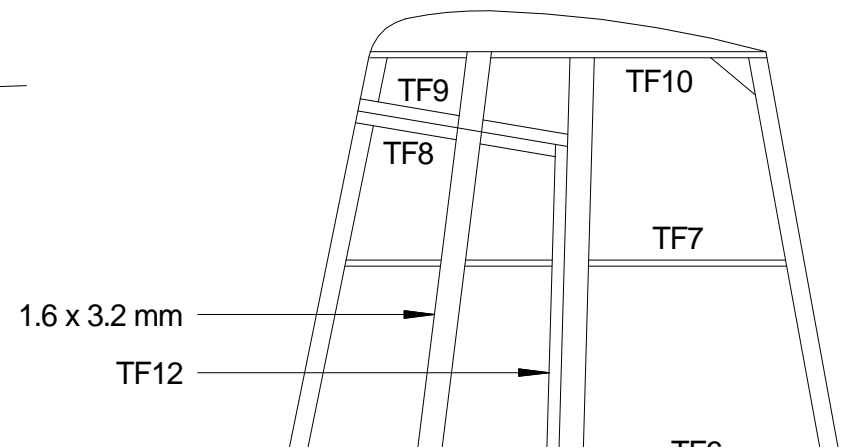
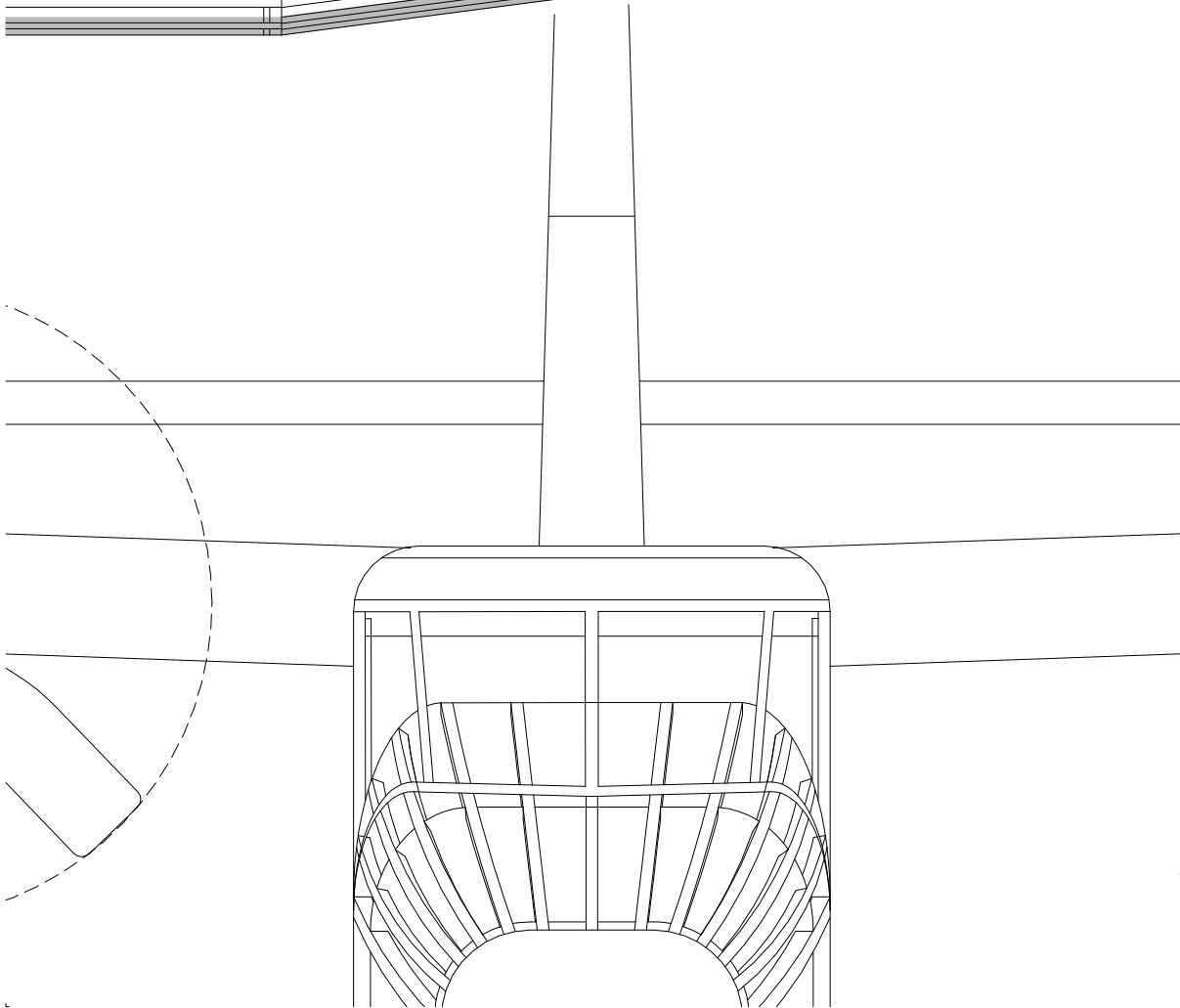

Lift struts from hard 2.4mm sheet (2 off)

Metric conversions:

0.8mm 1/32"  
1.6mm 1/16"  
2.4mm 3/32"  
3.2mm 1/8"  
4.8mm 3/16"  
6.4mm 1/4"

Wing construction:

- Pin down trailing edge and position lower spars
- Glue ribs in place
- Add leading edge and upper spars
- Shape leading edge and cut out section for engine nacelles

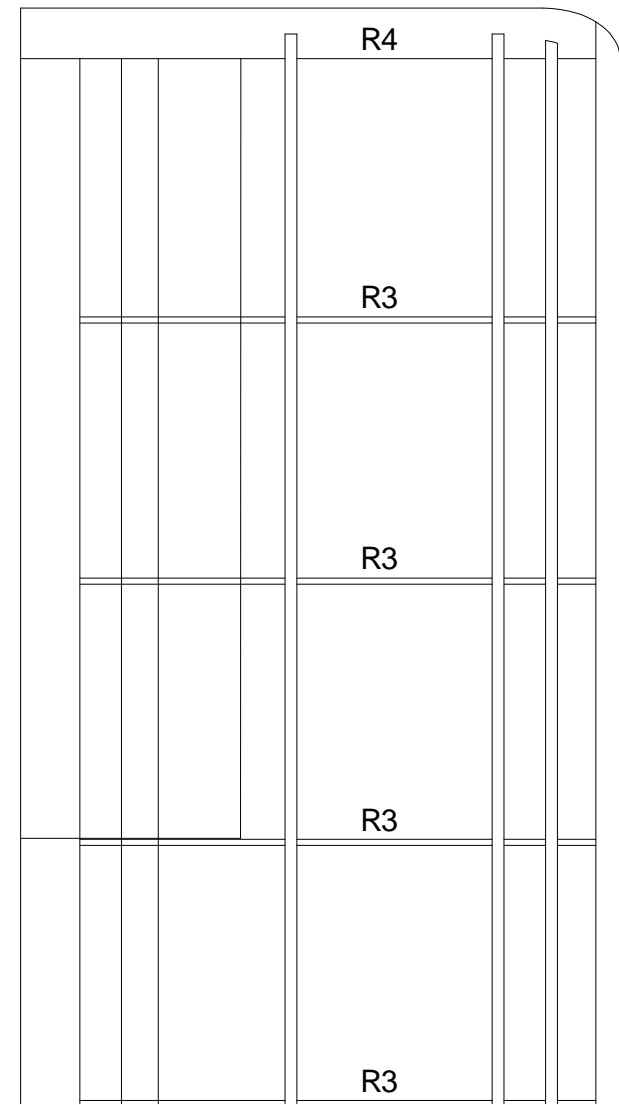
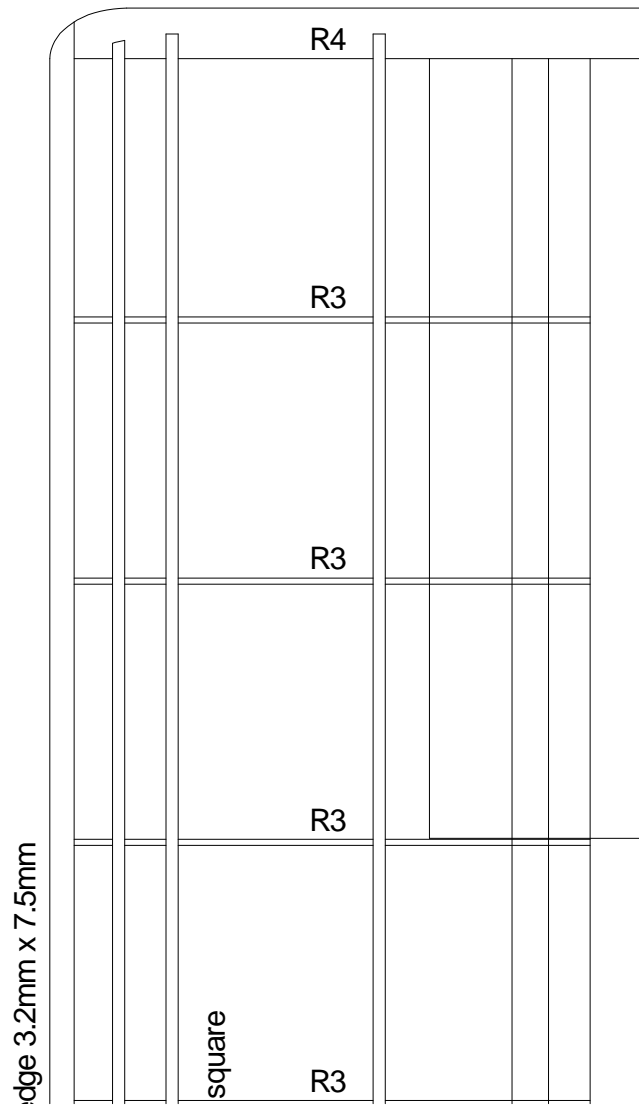

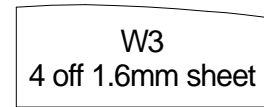
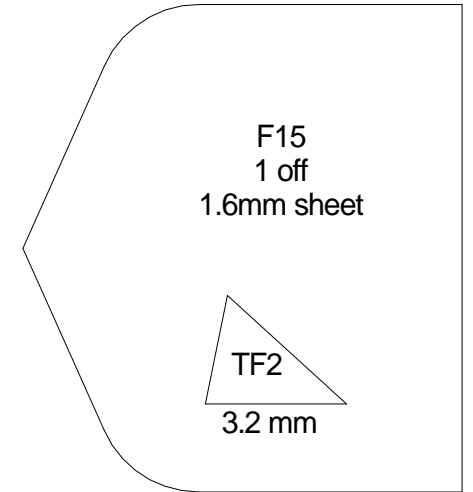
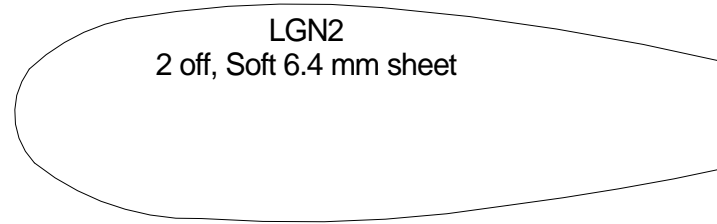
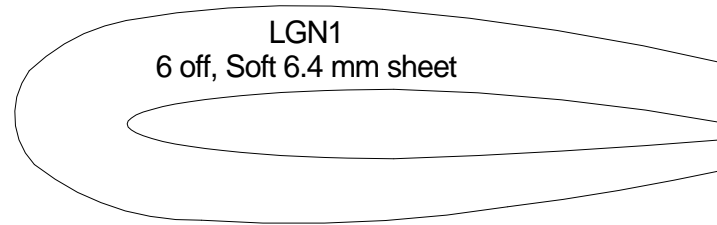
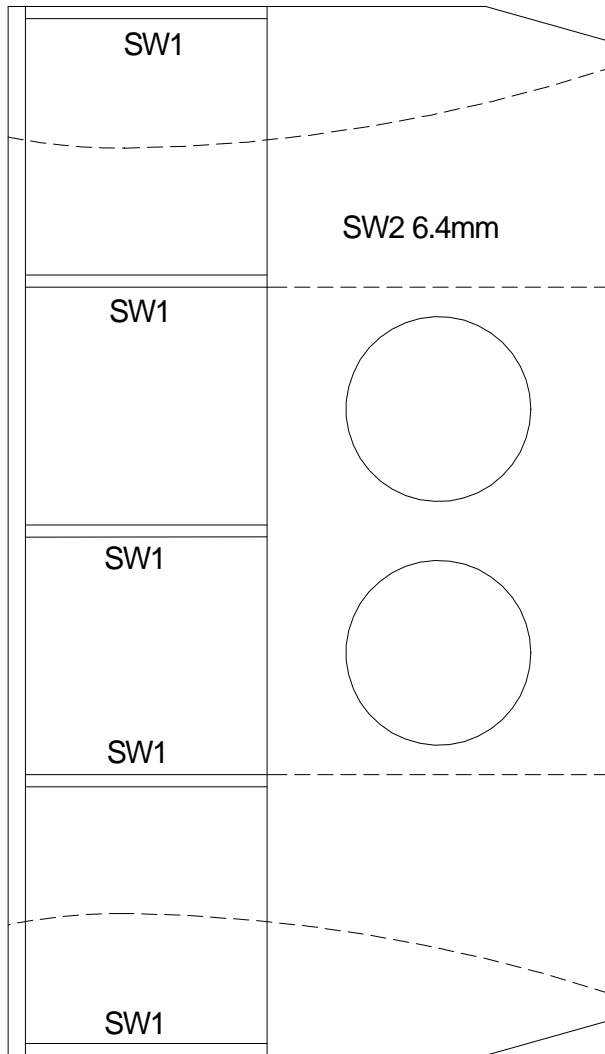

Instrument panel (glue to F4)

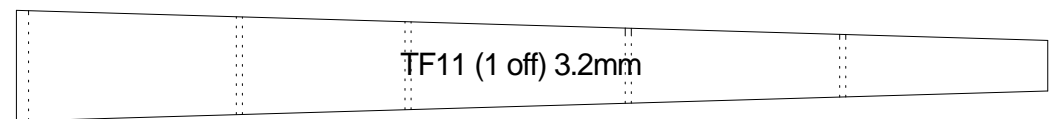
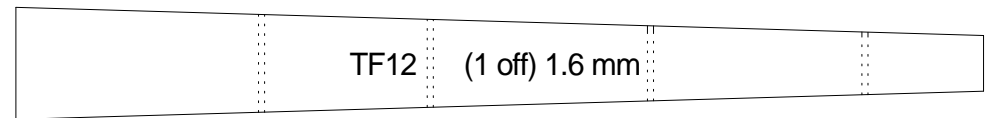
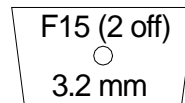
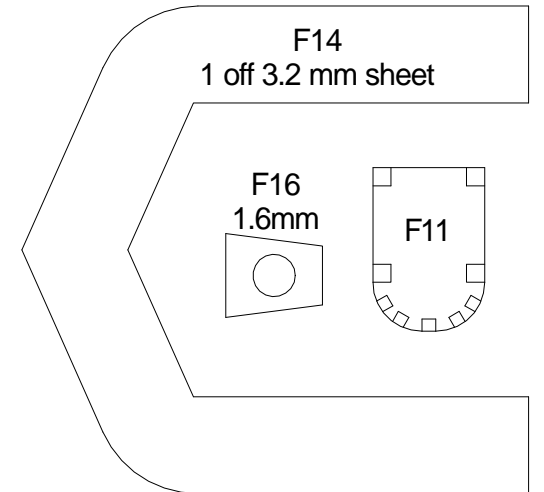
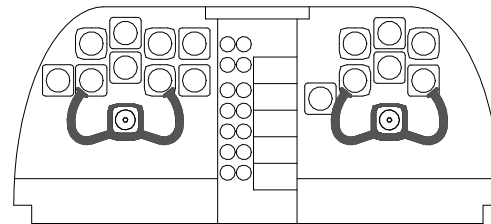

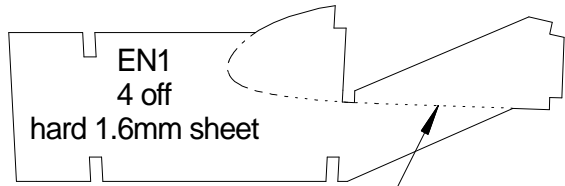

Location of EN4

